

NOTES:

All booths may be leased individually. The price for individual occupancy of any booth is listed in the appropriate rate plan herein depending on date of contract.

Shaded booths may be shared by two complementary exhibitors (i.e. a painter and a sculptor). Sharing of booths may be arranged by the applicant - subject to both exhibitors approval for exhibition - or upon request by Seafair.

The price for each applicant in a shared booth is 55% of the appropriate rate plan herein depending on date of contract.

Booth No.	RATE A	RATE B	RATE C	RATE D
	Regular Price	60+ Days in Advance (20% Savings)	120+ Days in Advance (30% Savings)	180+ Days in Advance (40% Savings)
101	\$25,600	\$20,480	\$17,920	\$15,360
102	\$28,450	\$22,760	\$19,915	\$17,070
103	\$17,900	\$14,320	\$12,530	\$10,740
104	\$31,750	\$25,400	\$22,225	\$19,050
105	\$29,050	\$23,240	\$20,335	\$17,430
106	\$20,750	\$16,600	\$14,525	\$12,450
107	\$26,800	\$21,440	\$18,760	\$16,080
108	\$30,550	\$24,440	\$21,385	\$18,330
109	\$14,800	\$11,840	\$10,360	\$8,880
110	\$14,900	\$11,920	\$10,430	\$8,940

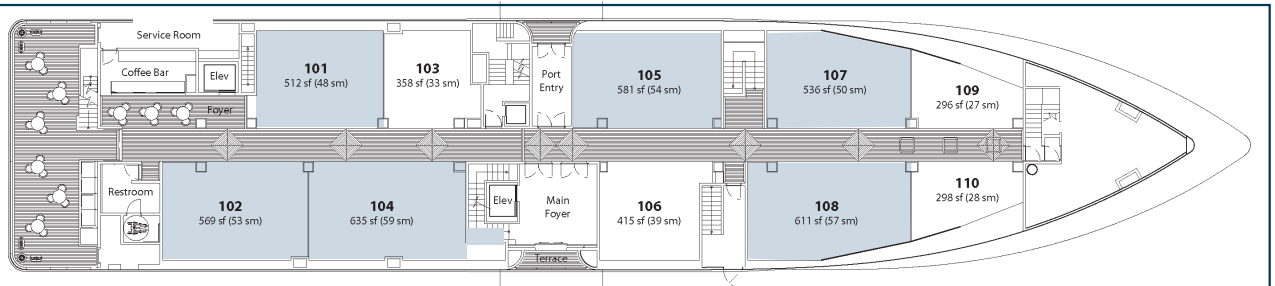

201	\$12,750	\$10,200	\$8,925	\$7,650
202	\$23,450	\$18,760	\$16,415	\$14,070
203	\$21,450	\$17,160	\$15,015	\$12,870
204	\$20,000	\$16,000	\$14,000	\$12,000
205	\$23,400	\$18,720	\$16,380	\$14,040
206	\$21,950	\$17,560	\$15,365	\$13,170
207	\$30,600	\$24,480	\$21,420	\$18,360
208	\$24,900	\$19,920	\$17,430	\$14,940
209	\$24,000	\$19,200	\$16,800	\$14,400
210	\$24,000	\$19,200	\$16,800	\$14,400
211	\$18,750	\$15,000	\$13,125	\$11,250
212	\$20,200	\$16,160	\$14,140	\$12,120

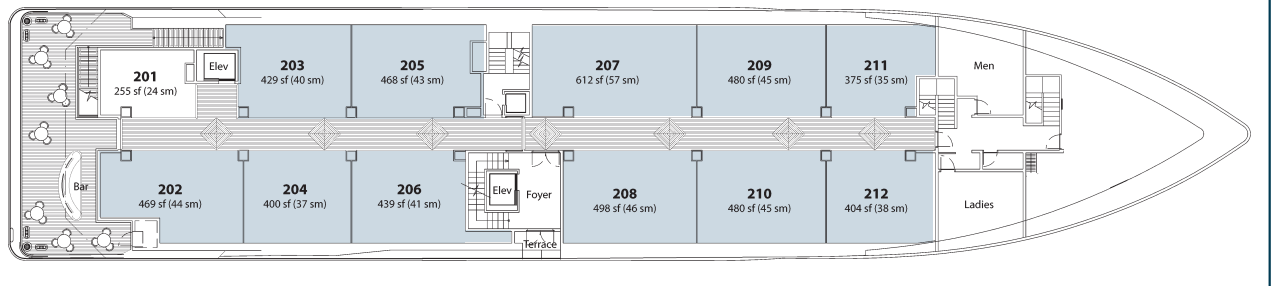

301	\$26,600	\$21,280	\$18,620	\$15,960
302	\$28,700	\$22,960	\$20,090	\$17,220
303	\$11,450	\$9,160	\$8,015	\$6,870
304	\$11,450	\$9,160	\$8,015	\$6,870
305	\$14,550	\$11,640	\$10,185	\$8,730
306	\$14,800	\$11,840	\$10,360	\$8,880

